

ORDINANCE NO. 12130

AN ORDINANCE TO AMEND ORDINANCE NO. 6958, AS AMENDED, KNOWN AS THE ZONING ORDINANCE, SO AS TO REZONE A TRACT OF LAND LOCATED AT 61 EAST MAIN STREET, MORE PARTICULARLY DESCRIBED HEREIN AND AS SHOWN ON THE MAP ATTACHED HERETO AND MADE A PART HEREOF BY REFERENCE, FROM M-1 MANUFACTURING ZONE TO C-3 CENTRAL BUSINESS ZONE, SUBJECT TO CERTAIN CONDITIONS.

SECTION 1. BE IT ORDAINED BY THE CITY COUNCIL OF THE CITY OF CHATTANOOGA, TENNESSEE, That Ordinance No. 6958, as amended, known as the Zoning Ordinance, be and the same hereby is amended so as to rezone:

Lot 21, Block 8, Stanton's Addition to Chattanooga as shown in Book Y, Volume 2, Page 156, and being the property described in Deed Book 5512, Page 721, ROHC. Tax Map 145LA-C-001.

from M-1 Manufacturing Zone to C-3 Central Business Zone.

SECTION 2. BE IT FURTHER ORDAINED, That this rezoning shall be subject to:

For all new construction and major renovations affecting the building exteriors:

1. Review:
 - (a) To promote compliance with the Downtown Plan, to help ensure that new development complements the existing urban fabric, and to promote the preservation of historically or architecturally significant structures, all site plans, landscaping, and building elevations shall be reviewed by the Planning and Design Studio.
 - (b) Historically or architecturally significant structures should be preserved.

2. Setbacks and street frontage:

- (a) For commercial buildings a zero building setback is required along the street frontage.
- (b) To accommodate outdoor pedestrian activities such as a park, plaza, or outdoor dining, a greater setback may be permitted if an edge delineating the public and private space is provided.
- (c) This edge shall have a minimum height of three feet and a maximum height of four feet above grade and shall consist of brick, stucco, or stone walls (concrete block can only be used when faced with said materials), decorative metal fences, cast iron, or composite material. When fences are used, landscaped hedges must also be included. Highway-style guardrails or security fencing (e.g. chain link) shall not be permitted.

3. Building facades and access:

- (a) The primary pedestrian entrance shall be provided from the primary street.
- (b) Ground floor openings (doors and windows) shall constitute a minimum of 50 percent of the ground floor façade area for commercial buildings.
- (c) No security-type roll up metal doors shall be permitted to front streets other than interior block alleys.
- (d) The height of new buildings shall be 18 feet minimum and 48 feet maximum.

4. Placement of equipment:

All dumpsters and mechanical equipment shall be placed to the rear of the property and shall be screened from all public rights-of-way.

5. Access and Parking:

- (a) Parking shall be located behind the primary building.
- (b) For corner lots, or for cases where physical constraints such as topography do not allow for rear parking, any parking fronting a public street shall be screened along the public right-of-way as described under "Setbacks and Street Frontage" above.
- (c) Additional curb cuts shall not be permitted on the primary streets of the downtown street grid, such as (but not limited to) Broad, Market, 4th Street, Main, McCallie, and M.L. King Boulevard.

6. Landscaping:

To achieve the city's goal of a 15% tree canopy cover in the downtown, surface parking lots shall be landscaped with a minimum of one tree for every five parking spaces.

For residential buildings:

7. Uses Not Permitted:

Factory manufactured mobile homes constructed as a single self-contained unit and mounted on a single chassis are not permitted in the C-3 Zone.

8. Access and Parking:

- (a) Parking shall be located behind the primary building.
- (b) Alleys, where they exist, shall be used for vehicular access. In the absence of alleys, secondary streets should be used for vehicular access. Shared drives should be used wherever possible.

(c) Additional curb cuts shall not be permitted on the primary streets of the downtown street grid, such as (but not limited to) Broad, Market, 4th Street, Main, McCallie, and M.L. King Boulevard.

9. Setbacks:

Residential building setbacks should be consistent with the existing setbacks on the same side of the street.

SECTION 3. BE IT FURTHER ORDAINED, That this Ordinance shall take effect two (2) weeks from and after its passage.

PASSED on Second and Final Reading

May 20, 2008.

Linda Bennett
CHAIRPERSON

APPROVED: DISAPPROVED:

DATE: 5/27, 2008

[Signature]
MAYOR

/add



CHATTANOOGA
CASE NO: 2008-0072
PC MEETING DATE: 4/14/2008
FROM: M-1
TO: C-3

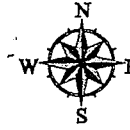

1 in. = 70.0 feet

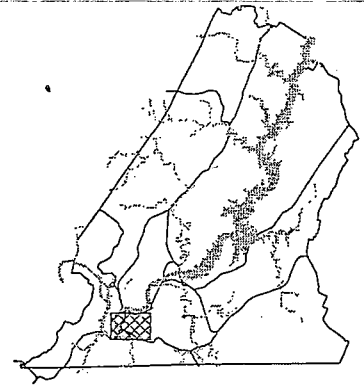

PLANNING COMMISSION RECOMMENDATION FOR CASE NO. 2008-072: Approve, subject to certain conditions as listed in the Planning Commission Resolution.

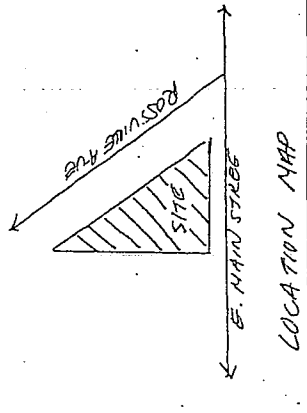
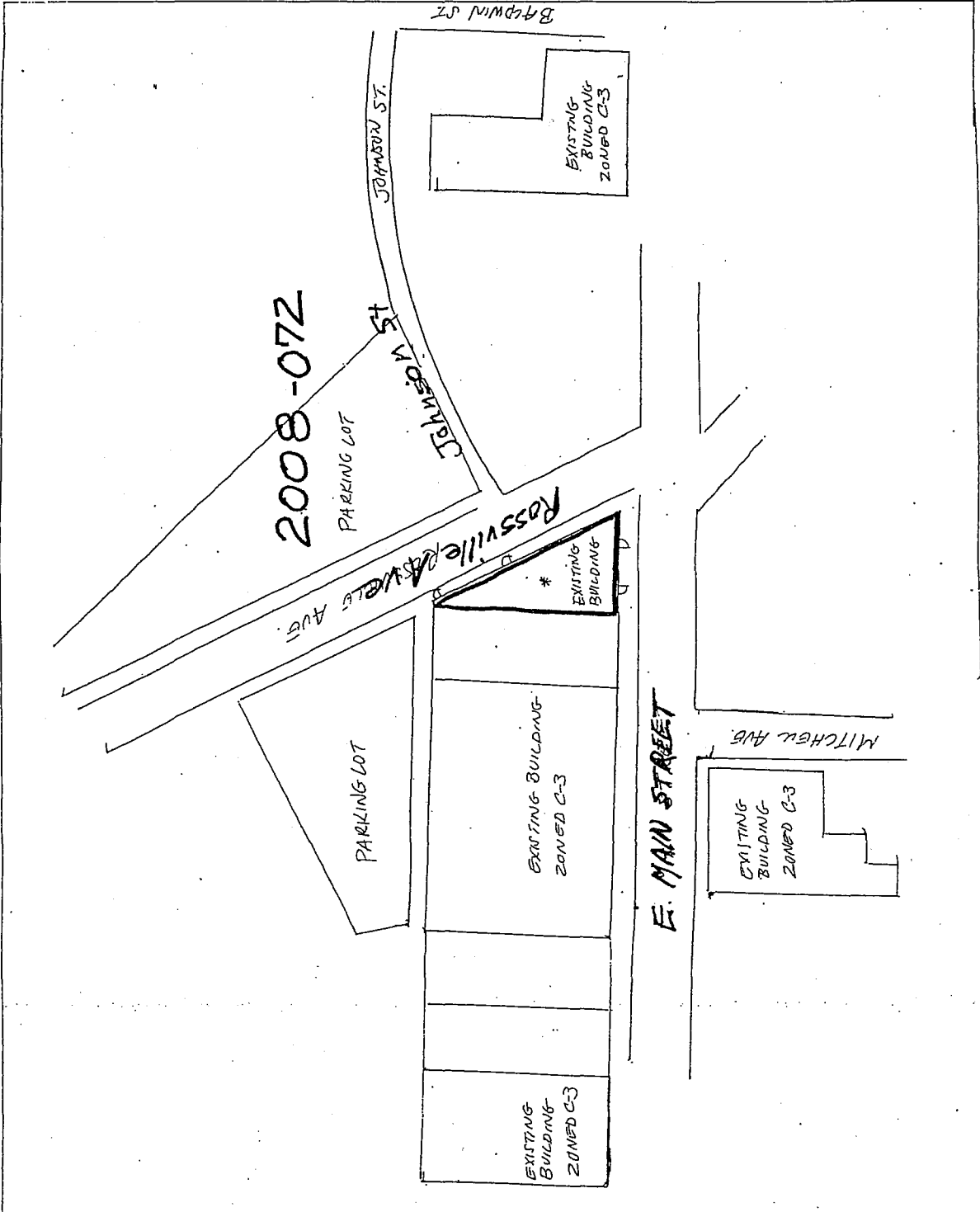

NOTES:
 A. CURRENT ZONING M-1
 B. 4600 sq. ft. (2300 sq. ft. SIDE)
 C. USE EXISTING BUILDING

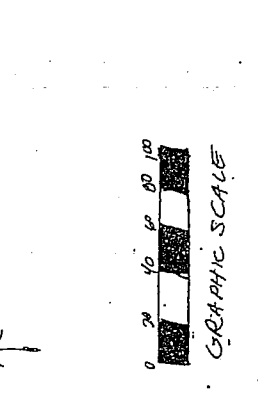

SCALE:
 TAX MAP NO. 1951A-C-001
 PARCEL NO. 1951A-C-001

JEFF CANNON / GREEN SPACES
 880 MARLET ST
 SECOND FLOOR
 CHATTANOOGA TN 37402
 JEFF@GREENSPACESCHATTANOOGA.COM